

NITURI PENTRU APLICATII SPECIALE

BULBEX Seria BF01

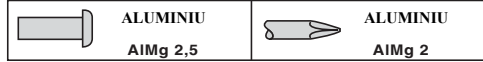

Nituri materiale subtiri, otel, mase plastice, fibra de sticla, lemn, compozite si combinatiile lor

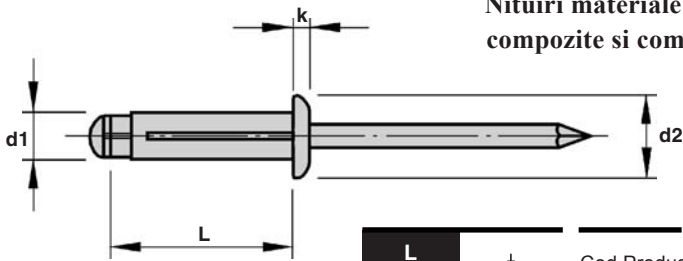

Dimensiuni (mm)

d1 Ø	Ø : 4.2 - 4.3
d2 Ø	: 8.0
k	: 1.4
P	: ≥ 31
d3	: ≈ 2.3
⌀	: 1000 N
⊥	: 600 N

4.0

+0.05
-0.15

L	⌀	Cod Produs
[+1/-0.2]	↑	
13.6	1.0- 3.0	BF010516
18.8	1.0- 7.0	0523

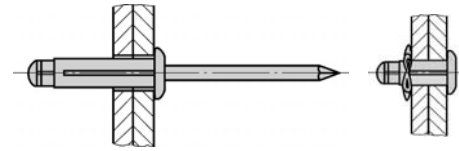

Dimensiuni (mm)

d1 Ø	Ø : 5.0 - 5.1
d2 Ø	: 9.8
k	: 1.9
P	: ≥ 31
d3	: ≈ 2.8
⌀	: 1200 N
⊥	: 900 N

4.8

+0.05
-0.15

L	⌀	Cod Produs
[+1/-0.2]	↑	
15.3	1.0- 4.0	BF010619
20.5	1.0- 9.0	0625
24.0	4.0-12.0	0630

TLR Seria 3904

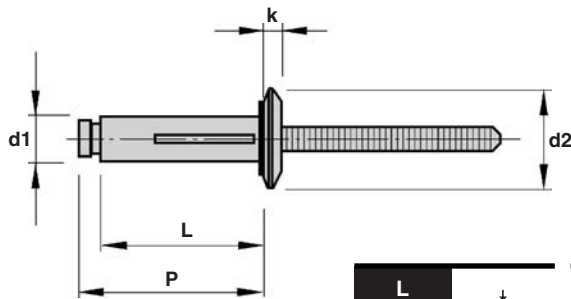
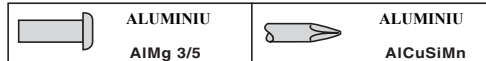

Dimensiuni (mm)

d1 Ø	Ø : 5.3 - 5.6
d2 Ø	: 11.5
k	: 2.1
P	: ≥ 25
d3	: ≈ 3.1
⌀	: 2050 N
⊥	

5.2

+0.05
-0.15

L	⌀	Cod Produs
[+1/-0.2]	↑	
20.0	0.5- 5.1	39040623
26.4	4.6-11.4	0633

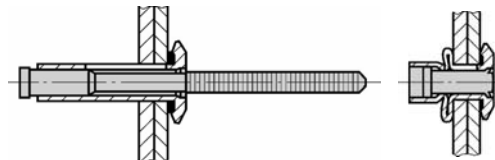

Dimensiuni (mm)

d1 Ø	Ø : 6.3 - 6.5
d2 Ø	: 13.9
k	: 2.6
P	: ≥ 31
d3	: ≈ 3.8
⌀	: 3300 N
⊥	: 5560 N

6.2

+0.05
-0.15

L	⌀	Cod Produs
[+1/-0.2]	↑	
25.9	3.1-10.2	39040832

HSN Seria 1803



A2 [1.4301]

Nituri acoperisuri, profile de etansare, conexiuni in beton sau caramida

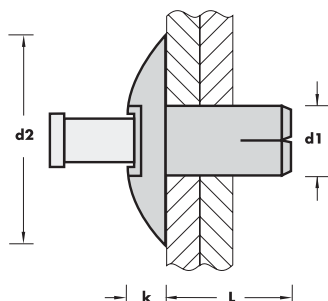

Dimensiuni (mm)

d1 Ø	Ø : 4.9
d2 Ø	: 16 [+/-0.4]
k	: 2.6 [+/-0.3]
⌀	: 2000 N
⊥	: 3500 N

4.8

+0.08
-0.15

L	⌀	Cod Produs
[+1/-0.2]	↑	
16	13.0-14.0	18034816
20	17.0-18.0	4820
25	22.0-23.0	4825
30	27.0-28.0	4830
35	32.0-33.0	4835
40	37.0-38.0	4840
45	42.0-43.0	4845
50	47.0-48.0	4850

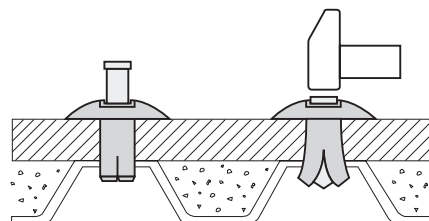

T-LOK Seria BM01

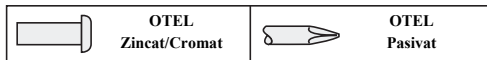

NITURI CU RUPEREA CAMASII

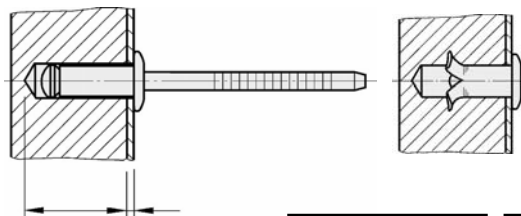
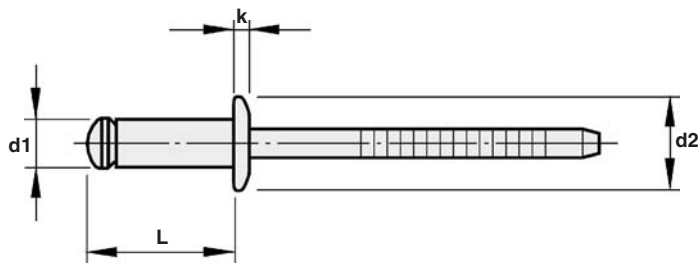

Dimensiuni (mm)		L [+1/-0.2]	Cod Produs
d1 \varnothing	\varnothing : 4.3 - 4.4	8.0	0.25-1.30 BM010510
d2 \varnothing	: 8.0	9.0	0.25-1.30 0512
k	: 1.2	16.0	0.25-7.60 0520
P	: ≥ 29		
d3	: ≈ 2.4		
	$\left[\begin{array}{c} \text{---} \\ \text{---} \end{array} \right]$: 740 N		
	$\left[\begin{array}{c} \text{---} \\ \text{---} \end{array} \right]$: -		

Dimensiuni (mm)		L [+1/-0.2]	Cod Produs
d1 \varnothing	\varnothing : 4.8 - 4.9	11.0	0.25-3.00 BM010614
d2 \varnothing	: 10.0	16.0	0.25-7.60 0620
k	: 2.0		
P	: ≥ 28		
d3	: ≈ 2.9		
	$\left[\begin{array}{c} \text{---} \\ \text{---} \end{array} \right]$: 920 N		
	$\left[\begin{array}{c} \text{---} \\ \text{---} \end{array} \right]$: -		

T-LOK Seria R1301

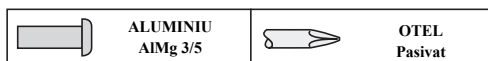

NITURI CU RUPEREA CAMASII SI PIERDEREA DORNULUI

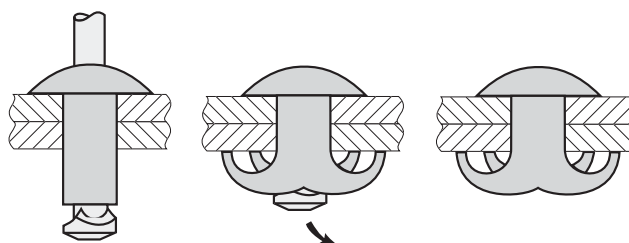
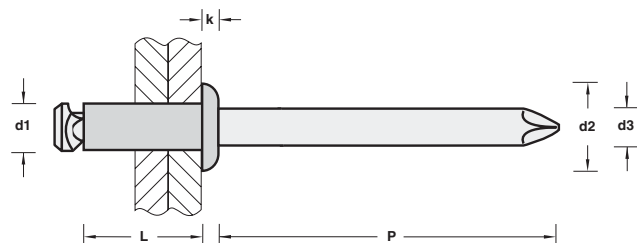

Dimensiuni (mm)		L [+1/-0.2]	Cod Produs
d1 \varnothing	\varnothing : 4.5 max.	10.0	1.5- 5.0 R13014010
d2 \varnothing	: 8.0 [+/-0.3]	12.0	4.0- 6.5 4012
k	: 1.2 [+/-0.2]	14.0	6.0- 9.0 4014
P	: ≥ 27	16.0	8.0-11.0 4016
d3	: 2.2	18.0	10.0-13.0 4018
	$\left[\begin{array}{c} \text{---} \\ \text{---} \end{array} \right]$: 1150 N	20.0	12.0-15.0 4020
	$\left[\begin{array}{c} \text{---} \\ \text{---} \end{array} \right]$: 1260 N	25.0	15.0-20.0 4025
		30.0	20.0-25.0 4030

Dimensiuni (mm)		L [+1/-0.2]	Cod Produs
d1 \varnothing	\varnothing : 5.3 max.	10.0	0.5- 4.0 R13014810
d2 \varnothing	: 9.5 [+/-0.3]	12.0	2.0- 6.0 4812
k	: 1.3 [+/-0.2]	14.0	4.0- 8.0 4814
P	: ≥ 27	16.0	6.0-10.0 4816
d3	: 2.6	18.0	8.0-12.0 4818
	$\left[\begin{array}{c} \text{---} \\ \text{---} \end{array} \right]$: 2400 N	20.0	10.0-14.0 4820
	$\left[\begin{array}{c} \text{---} \\ \text{---} \end{array} \right]$: 2200 N	22.0	12.0-16.0 4822
		25.0	16.0-19.0 4825
		30.0	19.0-24.0 4830
		35.0	24.0-29.0 4835
		40.0	29.0-34.0 4840

NIT CU RIZURI Seria R1601

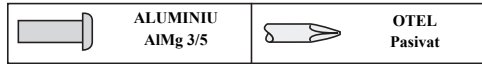

DIN 7337

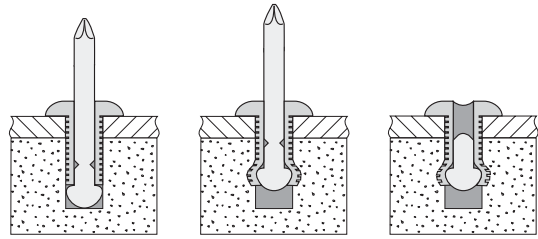
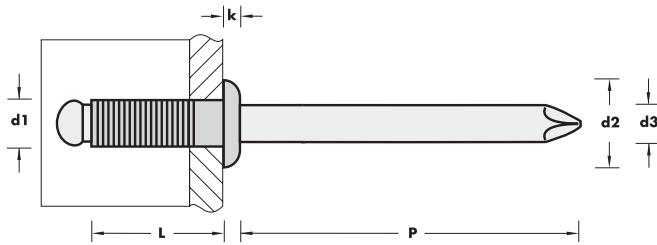

Dimensiuni (mm)		L [+1/-0.2]	Cod Produs
d1 ∅ 3.2 +0.35 -0	∅ : 3.4	10.0 max. 6.0	R16013210
	d2 ∅ : 6.0 [+/-0.24]	14.0 max. 10.0	3214
	k : ≤1.4		
	P : ≥26		
	d3 : 1.8		
	∅ : 930 N		
		∅ : 525 N	

Dimensiuni (mm)		L [+1/-0.2]	Cod Produs	
d1 ∅ 4.8 +0.35 -0	∅ : 5.1	8.0 max. 2.0	R16014808	
	d2 ∅ : 9.5 [+/-0.3]	10.0 max. 6.0	4810	
	k : ≤2.0	11.0 max. 7.0	4811	
	P : ≥27	12.0 max. 8.0	4812	
	d3 : 2.65	14.0 max. 10.0	4814	
	∅ : 1575 N	16.0 max. 12.0	4816	
		∅ : 1185 N	18.0 max. 14.0	4818
			20.0 max. 16.0	4820
			25.0 max. 21.0	4825
			30.0 max. 26.0	4830

Dimensiuni (mm)		L [+1/-0.2]	Cod Produs
d1 ∅ 4.0 +0.35 -0	∅ : 4.3	8.0 max. 4.0	R16014008
	d2 ∅ : 8.0 [+/-0.3]	10.0 max. 6.0	4010
	k : ≤1.7	12.0 max. 8.0	4012
	P : ≥27	16.0 max. 10.0	4016
	d3 : 2.2		
	∅ : 1410 N		
		∅ : 885 N	

CAPISOANE DE PLASTIC

Se butoneaza pe capul nitului dupa montaj

Dimensiuni (mm)

Gama niturilor receptoare		Culoare		Cod Produs	
Tip	Cod Produs				
AVEX ∅ 4.8	16920621	Alb	RAL 9010	16890600	
	16920631	Negru	RAL 9005	16890601	
	16430621	Bej	RAL 1001	16890617	
	16430631	Maro	RAL 8011	16890610	
		Rosu	RAL 7011	16890622	
BULBEX ∅ 4.0	BF010516	Alb	RAL 9010	11960500	
	BF010523	Negru	RAL 9005	11960501	
BULBEX ∅ 4.8	BF010619	Alb	RAL 9010	11960600	
	BF010625	Negru	RAL 9005	11960601	
	BF010630				
T-LOK ∅ 4.8	BM010614	Alb	RAL 9010	11960600	
	BM010620	Negru	RAL 9005	11960601	