

# NITURI STRUTTURALE SPECIALE

## MASTERLOCK Seria 1471

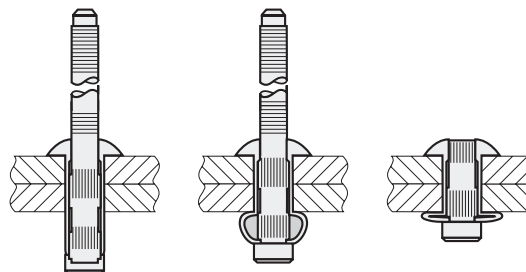
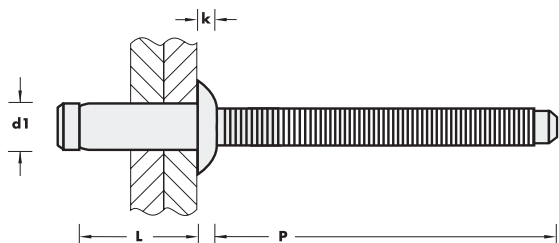

Dimensioni (mm)		L [+1/-0.2]	Cod Produs
d1 Ø	Ø : 5.0	9.0 1.5- 3.5	14714809
d2 Ø	: 9.8 [+/-0.30]	11.5 3.5- 6.0	4811
k	: 2.2 [+/-0.2]	14.0 6.0- 8.5	4814
P	: ≥32	16.5 8.5-11.0	4816
d3	: 3.0		
	⊕ : 3500 N		
	⊖ : min. 3920 N/max. 6270 N		

Dimensioni (mm)		L [+1/-0.2]	Cod Produs
d1 Ø	Ø : 6.6	10.5 2.8- 4.8	14716410
d2 Ø	: 13.0 [+/-0.30]	12.5 4.8- 6.8	6412
k	: 3.0 [+/-0.2]	14.5 6.8- 8.8	6414
P	: ≥32	16.5 8.8-10.8	6416
d3	: 4.2	18.5 10.8-12.8	6418
	⊕ : 6470 N	20.5 12.8-14.8	6420
	⊖ : min. 6860N/max. 11180 N		

## MASTERLOCK Seria 1472

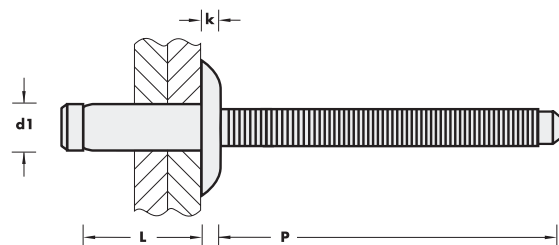
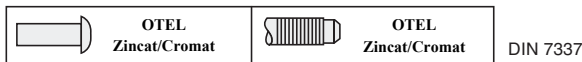

### CAP LARG

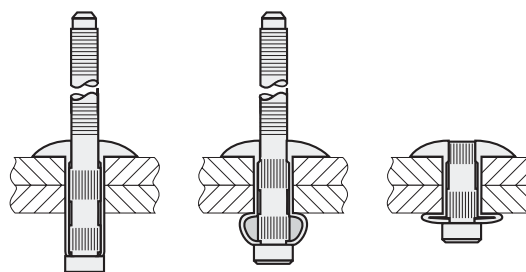

Dimensioni (mm)		L [+1/-0.2]	Cod Produs
d1 Ø	Ø : 5.0	9.0 1.5- 3.5	14724809
d2 Ø	: 14.0 [+/-0.30]	11.0 3.5- 6.0	4811
k	: 2.0 [+/-0.2]		
P	: ≥32		
d3	: 3.0		
	⊕ : 3500 N		
	⊖ : 6000 N		

## MASTERLOCK Seria 1474

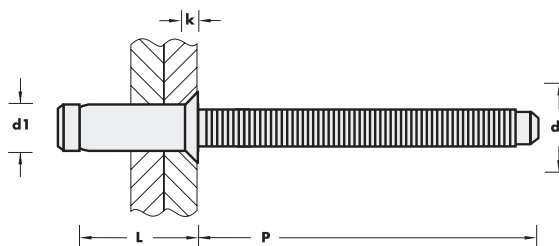
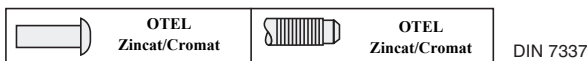

### CAP INECAT

Dimensioni (mm)		L [+1/-0.2]	Cod Produs
d1 Ø	Ø : 6.6	11.5 3.8- 5.8	14746411
d2 Ø	: 10.0 [+/-0.30]	12.5 4.8- 6.8	6412
k	: 2.0 [+/-0.2]	13.5 5.8- 7.8	6413
P	: ≥32	15.5 7.8- 9.8	6415
d3	: 4.2	17.5 9.8-11.8	6417
	⊕ : 5400 N	19.5 11.8-13.8	6419
	⊖ : 9300 N		

## HEMLOK Seria 2221

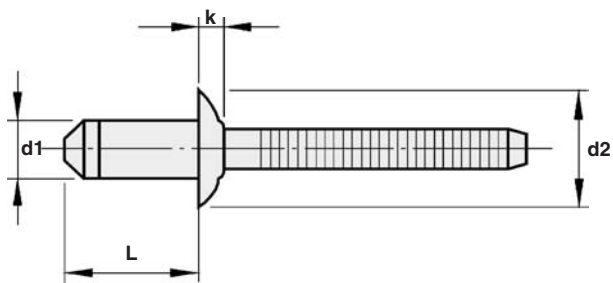
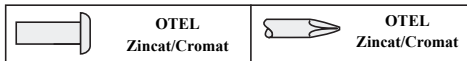

Dimensiuni (mm)

d1 Ø	Ø : 6.7 - 6.9
<b>6.5</b>	d2 Ø : 13.1
+0.05	k : 2.6
-0.15	P :
	d3 : ≈ 4.2
	⊕ : 9000 N
	⊖ : 12500-16000 N*

L		Cod Produs
[+1/-0.2]		
13.0	1.5- 3.5	22210812
14.3	2.8- 4.8	0813
14.9	3.4- 5.4	0814
16.3	4.8- 6.8	0815
18.3	6.8- 8.8	0817
19.0	7.5- 9.5	0818
20.3	8.8-10.8	0819
22.3	10.8-12.8	0821

## HEMLOK Seria 2241

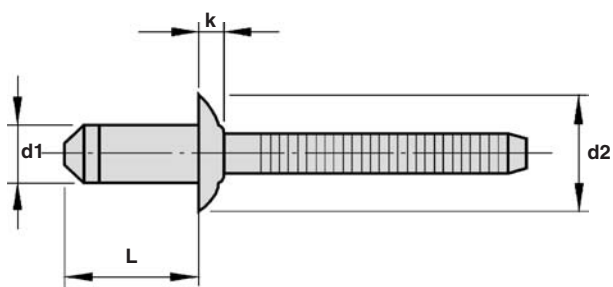

Dimensiuni (mm)

d1 Ø	Ø : 6.7 - 6.9
<b>6.5</b>	d2 Ø : 13.1
+0.05	k : 2.6
-0.15	P :
	d3 : ≈ 4.2
	⊕ : 2700-3130 N*
	⊖ : 6220-7450 N*

L		Cod Produs
[+1/-0.2]		
13.0	1.5- 3.5	22410812
14.3	2.8- 4.8	0813
16.3	4.8- 6.8	0815
18.3	6.8- 8.8	0817
20.3	8.8-10.8	0819
22.3	10.8-12.8	0821

\* (Dupa lungimea nitului)

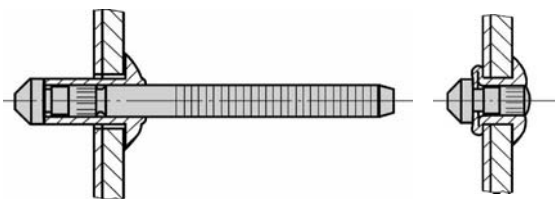

## MONOBOLT Seria 2771

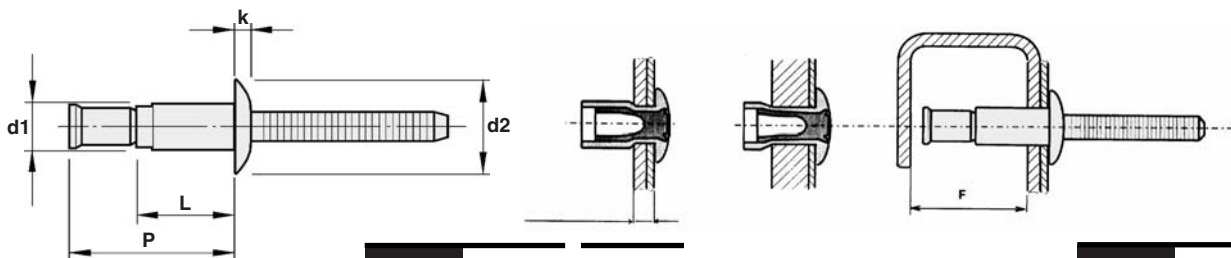
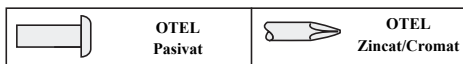

Dimensiuni (mm)

<b>d1</b> ∅	∅ <b>5.0</b> : 4.9 - 5.1
<b>d2</b> ∅	: 9.8
<b>k</b>	: 1.9
<b>P</b>	: ≥ 28
<b>d3</b>	: ≈ 3.0
	: 4450 N
	: 6200 N

L		Cod Produs
[+1/-0.2]		
10.5	1.6- 6.9	27710613
13.8	1.6-11.1	0617

Dimensiuni (mm)

<b>d1</b> ∅	∅ <b>6.5</b> : 6.6 - 6.7
<b>d2</b> ∅	: 13.1
<b>k</b>	: 2.7
<b>P</b>	: ≥ 29
<b>d3</b>	: ≈ 4.0
	: 9650 N
	: 11950 N

L		Cod Produs
[+1/-0.2]		
14.2	2.0- 9.5	27710817
19.3	2.0-15.9	27710824

## MONOBOLT Seria 2774

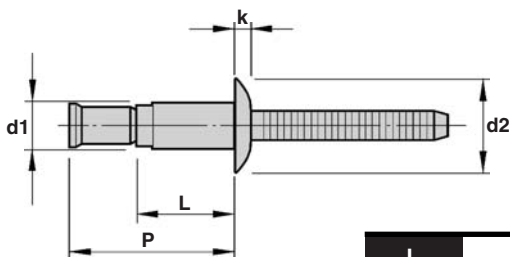
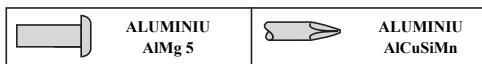

Dimensiuni (mm)

<b>d1</b> ∅	∅ <b>5.0</b> : 4.9 - 5.1
<b>d2</b> ∅	: 9.8
<b>k</b>	: 1.9
<b>P</b>	: ≥ 29
<b>d3</b>	: ≈ 3.0
	: 2200 N
	: 2450 N

L		Cod Produs
[+1/-0.2]		
10.5	1.6- 6.9	27740613
13.8	1.6-11.1	0617

Dimensiuni (mm)

<b>d1</b> ∅	∅ <b>6.5</b> : 6.0 - 7.0
<b>d2</b> ∅	: 13.1
<b>k</b>	: 2.7
<b>P</b>	: ≥ 29
<b>d3</b>	: ≈ 4.0
	: 4150 N
	: 5800 N

L		Cod Produs
[+1/-0.2]		
14.2	2.0- 9.5	27740817
19.3	2.0-15.9	0824

## MONOBOLT Seria 2711

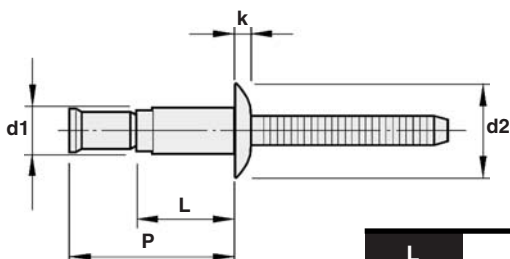
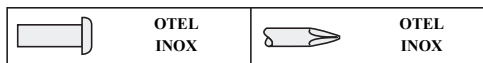

Dimensiuni (mm)

<b>d1</b> ∅	∅ <b>5.0</b> : 4.9 - 5.1
<b>d2</b> ∅	: 9.8
<b>k</b>	: 1.9
<b>P</b>	: ≥ 27
<b>d3</b>	: ≈ 3.0
	: 5800 N
	: 7000 N

L		Cod Produs
[+1/-0.2]		
10.5	1.6- 6.9	27110613
13.8	1.6-11.1	0617

Dimensiuni (mm)

<b>d1</b> ∅	∅ <b>6.5</b> : 6.0 - 7.0
<b>d2</b> ∅	: 13.1
<b>k</b>	: 2.7
<b>P</b>	: ≥ 29
<b>d3</b>	: ≈ 4.0
	: 9650 N
	: 10650 N

L		Cod Produs
[+1/-0.2]		
14.2	2.0- 9.5	27110817
19.3	2.0-14.6	0824